

AutoMatrix[®] Snippers⁺ & Catch-Tray

Illustrated Technique Guide

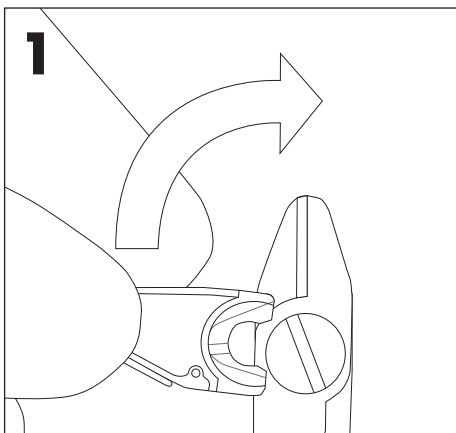



1
Attach Catch-Tray from the left side then turn 90° in the instrument axis.

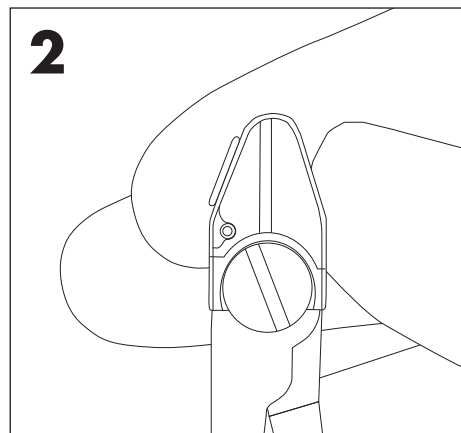

2
Make sure that the Catch-Tray is properly connected to the Snippers+.

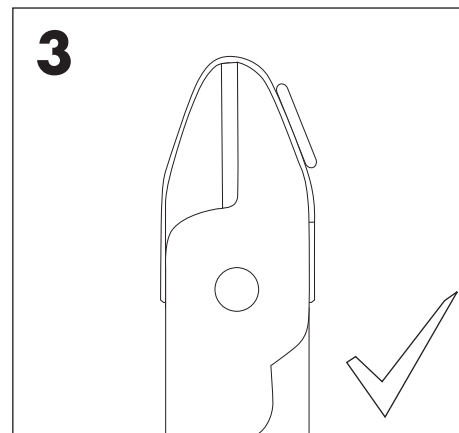

3
Important: Turn instrument and check that there is no gap between Catch-Tray and Snippers+.

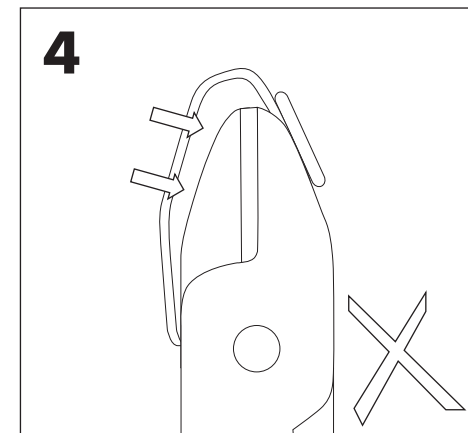

4
Gap leads to malfunction of the Snippers+ and Catch-Tray cannot prevent clipped loop pieces from the oral cavity.

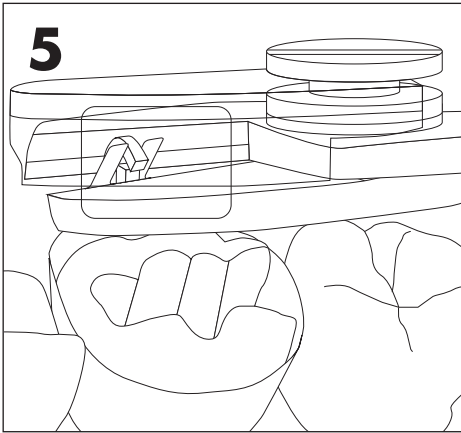

Clip any part of the projecting end of the AUTO-LOCK LOOP.

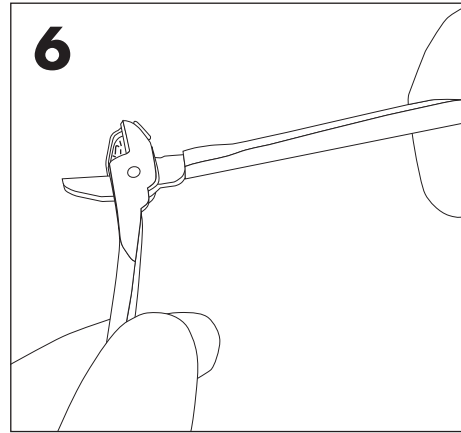

For loosening of Catch-Tray, open Snippers+ as widely as possible.

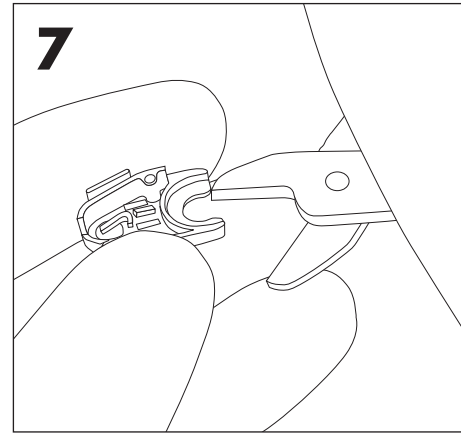

Pull off Catch-Tray with clipped pieces from the Snippers+.

Manufactured by:
DENTSPLY DeTREY GmbH,
De-Trey-Str. 1
78467 Konstanz
GERMANY

© DENTSPLY DeTREY 2014-08-08
www.dentsply.eu
www.dentsply.com



Caution, consult
instructions for use

For better dentistry

DENTSPLY